



DON'T FORGET
These instructions can be found in color and expandable at QA1.net

Technical Support Line: (952) 985-5675 Email: sales@QA1.net

INSTALLATION INSTRUCTIONS

QA1 P/N 5263, '67-'81 GM F-BODY & '68-'74 X-Body Solid Body Bushing Set

TOOLS AND SUPPLIES REQUIRED

- Floor Jack
- Wood Blocks
- Ratchet & Socket Set
- Torque Wrench

PRE-INSTALLATION NOTES-

Ensure all six body bushings (including two slightly smaller diameter for the frame/radiator support position) and hardware are on hand before beginning installation. Hardware listing on page 3.



INSTALLATION-

1. Beginning on the driver or passenger side, loosen the three body mounts but do not fully remove the bolts. The body mount locations are at the rear of the front subframe (**Figure 1**), near the front of the doors (**Figure 2**), and at the frame/radiator support. (**Figure 3**)

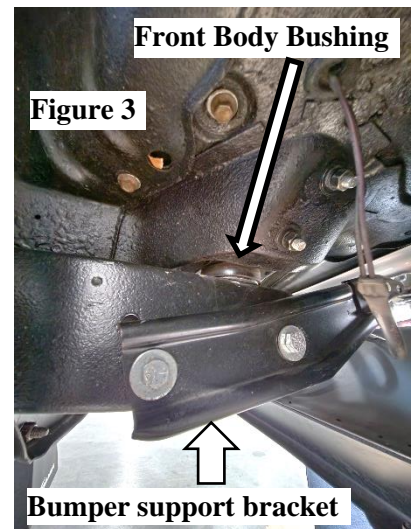

2. On the opposite side of the vehicle, remove all three body mounting bolts.
3. Remove the front bumper mounting bolts attached to the frame. **(Figure 3)** The front bumper may or may not have additional mounting that will hold it in place during the installation.
4. With all three body mounting bolts removed from one side of the vehicle, use a block of wood (on the same side) between the pinch weld and the frame rail to jack the body up enough to remove the rear body mount. **(Figure 4 & 5)**
5. Remove the middle body bushing and front bushing at the radiator support. **(Figure 6 & 7)**
6. Install one of the larger bushing halves (with 5/8" hole) on the rear and middle positions between the body and the frame with the shouldered end facing down. **(Figure 8)**



Figure 4



Figure 5

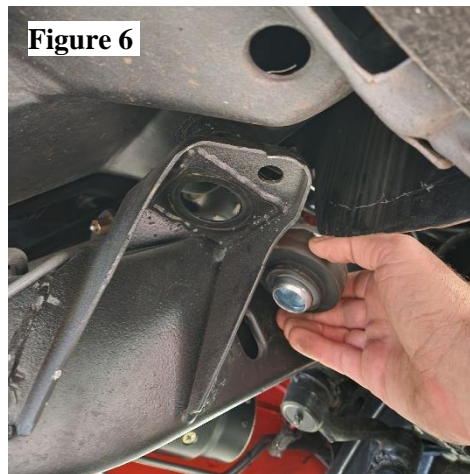

Figure 6

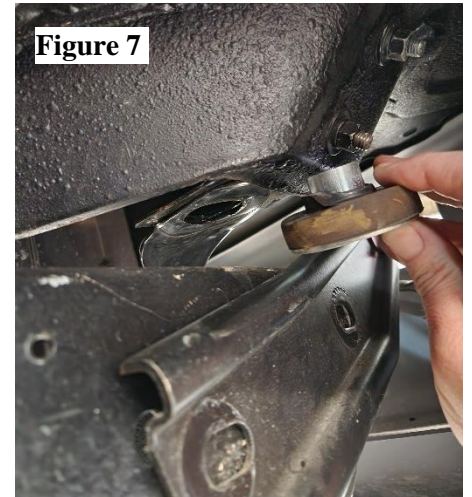

Figure 7

7. Lower the body enough to install the female cup on the bottom side of the rear and middle bushing position. Secure using 5/8" x 3" hardware with one washer on the rear and middle body bushing locations. This hardware should be left loose until all body bushings are installed.
8. Install one smaller diameter body bushings (with 1/2" hole) between the radiator support and frame with the shouldered end facing up. **(Figure 9)**



Figure 8



**Rear & Middle Bushing
Shoulder Installed
Facing Down.**

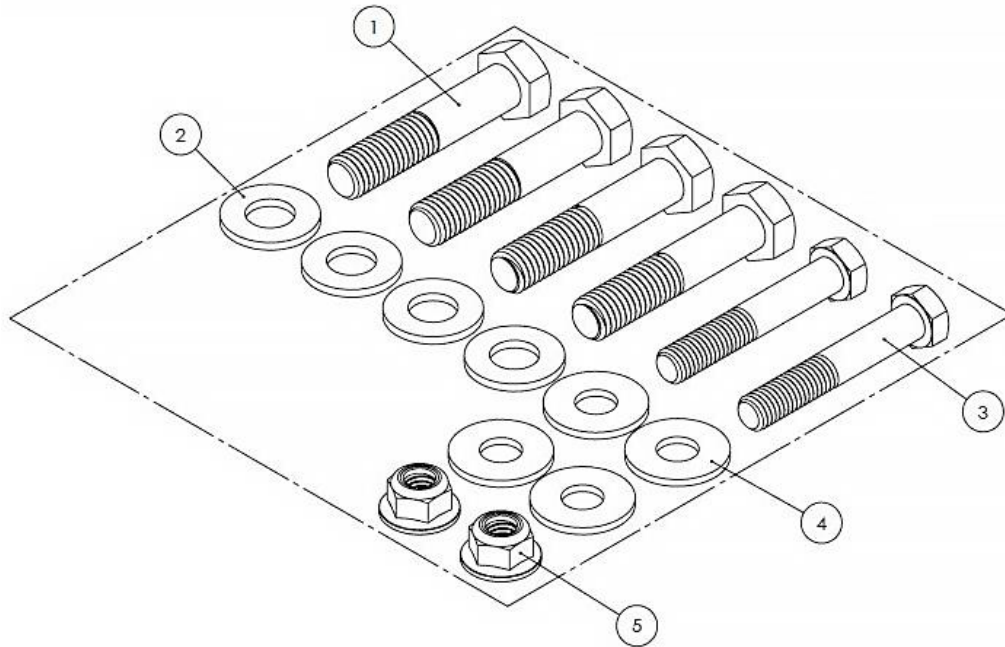

Figure 9

**Front Bushing
Position Shoulder UP.**

9. Install one 1/2" x 3" bolt with two 1/2" washers and one flanged nyloc nut to secure the front body bushing.
10. Fully lower the body and move to the opposite side of the vehicle to complete steps 3-9.
11. With all bushings installed, fully lower the body and torque the middle body bushings to 100 lb. ft.
12. Torque the rear body bushing to 100 lb. ft. and the front body bushings to 40 lb. ft.
13. Inspect all body bushings to ensure they are fully seated.
14. Reinstall the front bumper support bracket to frame bolts and torque to factory spec.
15. Double check all work. It's a basic and overlooked practice that distinguishes the most effective builders from the rest.

BALLOON #	QTY/KIT	DESCRIPTION	2ND DESCRIPTION	QA1 ITEM #	WHERE USED
1	4	BOLT, HEX 5/8-11 X 3.0"	GRADE 5, CLEAR ZINC	9012-342	REAR & BULKHEAD MOUNTS
2	4	WASHER, FLAT 5/8" SAE	.66" ID X 1.32" OD X .095", CLEAR ZINC	9005-257	
3	2	BOLT, HEX 1/2-13 X 3.0"	GRADE 5, CLEAR ZINC	N/A	RADIATOR SUPPORT
4	4	WASHER, FLAT 1/2" USS	.56" ID X 1.38" O.D. X .11", CLEAR ZINC	9005-126	
5	2	NUT, HEX FLANGE NYLOCK 1/2-13	GRADE N5, CLEAR ZINC	9014-539	





READ ALL INSTRUCTIONS CAREFULLY AND THOROUGHLY PRIOR TO STARTING INSTALLATION. PRODUCTS THAT HAVE BEEN INSTALLED ARE NOT ELIGIBLE FOR RETURN. USE THE PROPER JACKING LOCATIONS. DEATH OR SERIOUS INJURY CAN RESULT IF INSTRUCTIONS ARE NOT CORRECTLY FOLLOWED. A GOOD CHASSIS MANUAL, AVAILABLE AT YOUR LOCAL PARTS STORE, MAY ALSO AID IN YOUR INSTALLATION.

• **DISCLAIMER / WARRANTY** •

QA1 WARRANTS THAT THE PRODUCTS WILL BE FREE FROM DEFECTS IN MATERIAL AND WORKMANSHIP FOR ONE YEAR FROM DATE OF SALE TO THE ORIGINAL PURCHASER. QA1 MAKES NO OTHER WARRANTY OF ANY KIND, EXPRESSED OR IMPLIED. QA1 SHALL HAVE NO OBLIGATION UNDER THE FOREGOING WARRANTY WHERE THE DEFECT IS THE RESULT OF IMPROPER OR ABNORMAL USE, YOUR NEGLIGENCE, VEHICLE ACCIDENT, IMPROPER OR INCORRECT INSTALLATION OR MAINTENANCE, NOR WHEN THE PRODUCT HAS BEEN REPAIRED OR ALTERED IN ANY WAY. QA1'S LIABILITY IN THE CASE OF DEFECTIVE PRODUCTS SUBJECT TO THE FOREGOING WARRANTY SHALL BE LIMITED TO THE REPAIR OR REPLACEMENT, AT QA1'S OPTION, OF THE DEFECTIVE PRODUCTS.

THE USER UNDERSTANDS AND RECOGNIZES THAT RACING PARTS, SPECIALIZED STREET ROD EQUIPMENT, AND ALL PARTS AND SERVICES SOLD BY QA1 ARE EXPOSED TO MANY AND VARIED CONDITIONS DUE TO THE MANNER IN WHICH THEY ARE INSTALLED AND USED. QA1 SHALL BEAR NO LIABILITY FOR ANY LOSS, DAMAGE OR INJURY, EITHER TO A PERSON OR TO PROPERTY, RESULTING FROM THE INSTALLATION, DIRECT OR INDIRECT USE OF ANY QA1 PRODUCTS OR INABILITY BY THE BUYER TO DETERMINE PROPER USE OR APPLICATION OF QA1 PRODUCTS. WITH THE EXCEPTION OF THE LIMITED LIABILITY WARRANTY SET FORTH ABOVE, QA1 SHALL NOT BE LIABLE FOR ANY CLAIMS, DEMANDS, INJURIES, DAMAGES, ACTIONS, OR CAUSES OF ACTION WHATSOEVER TO BUYER ARISING OUT OF OR CONNECTED WITH THE USE OF ANY QA1 PRODUCTS. MOTORSPORTS ARE DANGEROUS; AS SUCH, NO WARRANTY OR REPRESENTATION IS MADE AS TO THE PRODUCT'S ABILITY TO PROTECT THE USER FROM INJURY OR DEATH. THE USER ASSUMES THAT RISK!

DEDICATED TECH SUPPORT

QA1 is dedicated to providing quality support and instructions. We employ passionate racers and car enthusiasts that know our products and the industry to better serve you.

CHECK US OUT ON YOUTUBE!



- Frequently Asked Questions
- Quick Tips
- Install Information
- Tuning and Repair Guides
- Other Technical Information



- [linkedin.com/company/qa1](https://www.linkedin.com/company/qa1)
- [instagram.com/qa1motorsports](https://www.instagram.com/qa1motorsports)
- [facebook.com/qa1motorsports](https://www.facebook.com/qa1motorsports)

www.qa1.net/tech

[youtube.com/qa1tech](https://www.youtube.com/qa1tech)