

# SCREW-IN STYLE

Part Number	Some Popular Applications	Location	Interchange		
			Moog®	Afco®	Howe®
1210-105 1210-300S 1210-200S 1210-201S 1210-238S	Fits Upper & Lower Tapers In Pinto Spindle, Small Chrysler, 62-78 Chrysler B-Body, 70-74 Chrysler E-Body, 73-76 Chrysler A-Body	Upper Mopar	K772	20034LF	22320
1210-102 1210-214S 1210-215S	71-76 Impala, Popular Late Models, Most Wide Type Cars	Lower GM	K6141T	20038LF	22410
1210-106 1210-216S 1210-217S	60-66 Imperial, Nearly All Strut Cars, Large Chrysler	Lower Mopar	K727 MP1003	20036LF	22412
1210-107 1210-206S 1210-207S	73-78 Charger, 73-74 GTX, 68-73 Road Runner, 79-80 Duster, Most Modifieds & Most Wide Type Cars	Lower Mopar	K719	20035	22418
1210-111 1210-212S 1210-213S	NASCAR, Willwood, Mustang II	Upper NASCAR	MP1002	-	-

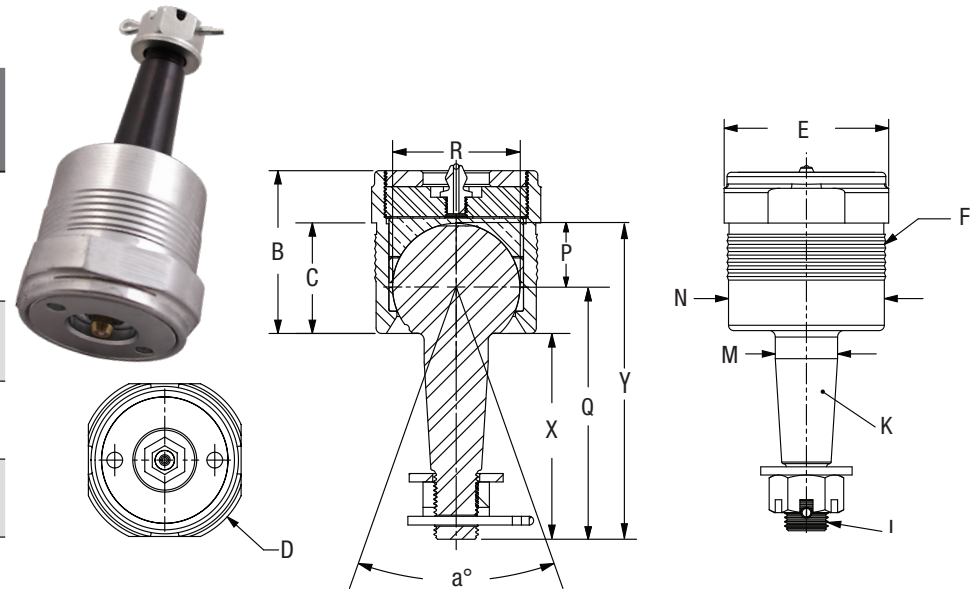

Part Number	Housing Only Part Number	Stud Only Part Number	Length Difference	Stud Length (X)	Stud Length (Y)	Misalign. Angle (a°)	Under Shoulder Length (C)	Housing Depth (B)	Shoulder OD (D)	Wrench Flat (E)	Thread Major Dia. (F)	Stud Taper (K)	Stud Thread (L)	Taper Major Dia. (M)	Housing OD (N)	Ball Center from Mounting Flange (P)	Ball Center to End of Stud (Q)	Ball Diameter (R)
1210-105	1210-505	9029-220	Standard	2.33	3.542	64	1.25	1.840	2.110	1.912	1.837	1.5:12	1/2-20	0.724	1.810	0.727	2.851	1.438
1210-300S	1210-505	9029-300	-0.3"	2.17	3.382	70	1.25	1.840	2.110	1.912	1.837	1.5:12	9/16-18	0.710	1.810	0.727	2.691	1.438
1210-200S	1210-505	9029-200	+0.1"	2.43	3.642	64	1.25	1.840	2.110	1.912	1.837	1.5:12	1/2-20	0.724	1.810	0.727	2.951	1.438
1210-201S	1210-505	9029-201	+0.5"	2.83	4.042	64	1.25	1.840	2.110	1.912	1.837	1.5:12	1/2-20	0.724	1.810	0.727	3.351	1.438
1210-238S	1210-505	9029-238	+1.0"	3.33	4.542	64	1.25	1.840	2.110	1.912	1.837	1.5:12	1/2-20	0.724	1.810	0.727	3.851	1.438
1210-102	1210-502	9029-223	Standard	2.41	3.848	42	1.39	2.047	2.308	1.953	2.012	2:12	5/8-18	0.830	1.953	0.744	3.06	1.625
1210-214S	1210-502	9029-214	+0.1"	2.51	3.948	42	1.39	2.047	2.308	1.953	2.012	2:12	5/8-18	0.830	1.953	0.744	3.16	1.625
1210-215S	1210-502	9029-215	+0.5"	2.91	4.348	42	1.39	2.047	2.308	1.953	2.012	2:12	5/8-18	0.830	1.953	0.744	3.56	1.625
1210-106	1210-506	9029-224	Standard	2.71	4.143	40	1.39	2.047	2.308	1.953	2.012	1.5:12	5/8-18	0.892	1.953	0.744	3.356	1.625
1210-216S	1210-506	9029-216	+0.1"	2.81	4.243	40	1.39	2.047	2.308	1.953	2.012	1.5:12	5/8-18	0.892	1.953	0.744	3.456	1.625
1210-217S	1210-506	9029-217	+0.5"	3.21	4.643	40	1.39	2.047	2.308	1.953	2.012	1.5:12	5/8-18	0.892	1.953	0.744	3.856	1.625
1210-107	1210-507	9029-225	Standard	2.66	3.871	64	1.25	1.840	2.110	1.912	1.837	1.5:12	5/8-18	0.780	1.810	0.727	3.181	1.438
1210-206S	1210-507	9029-206	+0.1"	2.76	3.971	64	1.25	1.840	2.110	1.912	1.837	1.5:12	5/8-18	0.780	1.810	0.727	3.281	1.438
1210-207S	1210-507	9029-207	+0.5"	3.16	4.371	64	1.25	1.840	2.110	1.912	1.837	1.5:12	5/8-18	0.780	1.810	0.727	3.681	1.438
1210-111	1210-511	9029-229	Standard	2.59	3.803	68	1.25	1.840	2.110	1.912	1.837	1.5:12	9/16-18	0.711	1.810	0.727	3.112	1.438
1210-212S	1210-511	9029-212	+0.1"	2.69	3.903	68	1.25	1.840	2.110	1.912	1.837	1.5:12	9/16-18	0.711	1.810	0.727	3.212	1.438
1210-213S	1210-511	9029-213	+0.5"	3.09	4.303	68	1.25	1.840	2.110	1.912	1.837	1.5:12	9/16-18	0.711	1.810	0.727	3.612	1.438

DIMENSIONS IN INCHES