

STUD & GREASE FITTING CONFIGURATIONS

T E C H N I C A L

ROD END STUD Specifications

ROD END STUD - INCH / METRIC

- Low Carbon Steel
- Protective Coated for Corrosion Resistance
- Right Hand Threads Standard
- Available with All Cataloged Rod Ends, Male and Female*

ROD END STUD CONFIGURATION

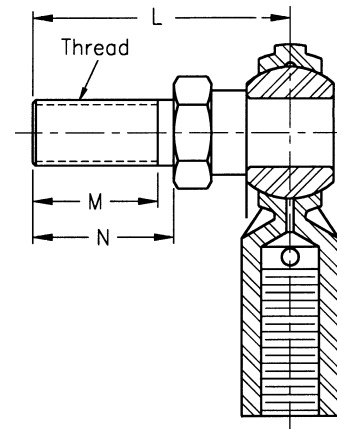

DIMENSIONS IN INCHES

Rod End Bore Size	L Ref.	N $\pm .010$	M Ref.	Thread UNF-2A
3/16	1.000	0.500	0.437	10-32
1/4	1.031	0.562	0.500	1/4-28
5/16	1.219	0.687	0.593	5/16-24
3/8	1.562	0.906	0.812	3/8-24
7/16	1.750	1.062	0.937	7/16-20
1/2	2.000	1.125	1.000	1/2-20
5/8	2.500	1.500	1.375	5/8-18
3/4	3.000	1.182	1.625	3/4-16

When ordering a standard stud, add the letter "S" to the completed rod end number. **Example: CMR8S**

If studded rod end is ordered with a grease fitting, the standard placement is in the right hand location with stud pointed toward the viewer. *Please specify if alternate placement is required.*

When ordering a stud and grease fitting, add the letter "S" and "Z" to the completed number. **Example: CMR8SZ**

* Please consult QA1 for availability of stainless steel, alloy steel and metric studs.

GREASE FITTING CONFIGURATION

Location

Standard grease fitting locations are illustrated at the right. Note that for a female configuration, once the male threaded component is fully engaged, the grease is forced through the hole at the top of the female shank to facilitate ball lubrication.

Standard Grease Fitting with Check Ball

Order by adding the letter "Z" to the completed number. **Example: CMR8Z**

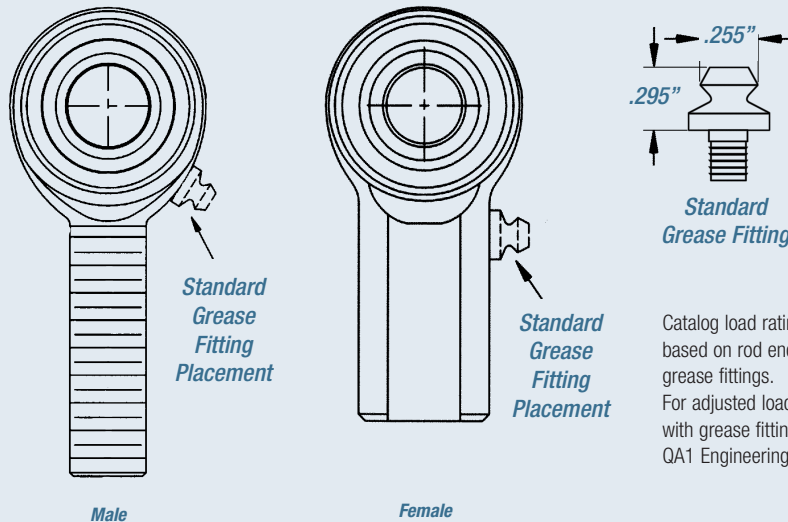

Standard Grease Fitting

Catalog load ratings are based on rod ends without grease fittings. For adjusted load ratings with grease fittings, consult QA1 Engineering.