

Weld-On Wrench Hexes & Jam Nuts

Related Products



Weld-On Wrench Hex Features

STANDARD WELD-ON WRENCH HEX
 • Fits several O.D. tube dimensions

DIMENSIONS IN INCHES

Weld-On Wrench Hexes

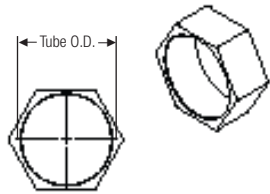

Part Number	Fits Tubing O.D. Size	Wrench Size	Part Number	Fits Tubing O.D. Size	Wrench Size
1865-101	3/8	5/8	1865-108	1 1/4	1 1/2
1865-102	1/2	3/4	1865-109	1 3/8	1 5/8
1865-103	5/8	7/8	1865-110	1 1/2	1 3/4
1865-104	3/4	1	1865-111	1 5/8	1 7/8
1865-105	7/8	1 1/8	1865-112	1 3/4	2
1865-106	1	1 1/4	1865-113	2	2 1/4
1865-107	1 1/8	1 3/8			

Jam Nut Features

STEEL JAM NUTS

- High Carbon Steel
- Chrome Plated
- Reference ANSI B18.2.2-1972
- Available in Inch and Metric

ALUMINUM JAM NUTS

- 7075-T6 Aluminum
- Clear Anodized



Steel Jam Nuts

PART NUMBER			DIMENSIONS IN INCHES		
Right Hand	Left Hand	Threads UNF-2B	H Hex	W Width	
JNR3S	JNL3S	10-32	3/8	0.139	
JNR4S	JNL4S	1/4-28	7/16	0.163	
JNR5S	JNL5S	5/16-24	1/2	0.195	
JNR6S	JNL6S	3/8-24	9/16	0.227	
JNR7S	JNL7S	7/16-20	11/16	0.260	
JNR8S	JNL8S	1/2-20	3/4	0.323	
JNR10S	JNL10S	5/8-18	15/16	0.387	
JNR10S-1	JNL10S-1	5/8-18	3/4	0.387	
JNR12S	JNL12S	3/4-16	1 1/8	0.425	
JNR14S	JNL14S	7/8-14	1 5/16	0.484	
JNR16S	JNL16S	1 1/4-12	1 7/8	0.719	
JNR16S-1	JNL16S-1	1-14	1 1/2	0.575	
JNR16S-2	JNL16S-2	1-12	1 7/8	0.575	

PART NUMBER			DIMENSIONS IN MILLIMETERS		
Right Hand	Left Hand	Threads 6H	H Hex	W Width	
MJNR5S	MJNL5S	M5 X 0.8	8.00	2.70	
MJNR6S	MJNL6S	M6 X 1.0	10.00	3.20	
MJNR8S	MJNL8S	M8 X 1.25	13.00	4.00	
MJNR8S-1	MJNL8S-1	M8 X 1.0	13.00	4.00	
MJNR10S	MJNL10S	M10 X 1.5	17.00	5.00	
MJNR10S-1	MJNL10S-1	M10 X 1.25	17.00	5.00	
MJNR12S	MJNL12S	M12 X 1.75	19.00	6.00	
MJNR12S-1	MJNL12S-1	M12 X 1.25	19.00	6.00	
MJNR14S	MJNL14S	M14 X 2.0	22.00	7.00	
MJNR14S-1	MJNL14S-1	M14 X 1.5	22.00	7.00	
MJNR16S	MJNL16S	M16 X 2.0	24.00	8.00	
MJNR16S-1	MJNL16S-1	M16 X 1.5	24.00	8.00	
MJNR20S	MJNL20S	M20 X 1.5	30.00	10.00	
MJNR20S-1	MJNL20S-1	M20 X 2.5	30.00	10.00	

Aluminum Jam Nuts

PART NUMBER			DIMENSIONS IN INCHES		
Right Hand	Left Hand	Threads UNF-2B	H Hex	W Width	
JNR4A	JNL4A	1/4-28	7/16	0.163	
JNR5A	JNL5A	5/16-24	1/2	0.195	
JNR6A	JNL6A	3/8-24	9/16	0.227	
JNR7A	JNL7A	7/16-20	11/16	0.260	
JNR8A	JNL8A	1/2-20	3/4	0.323	
JNR10A	JNL10A	5/8-18	15/16	0.387	
JNR10A-1	JNL10A-1	5/8-18	3/4	0.387	
JNR12A	JNL12A	3/4-16	1 1/8	0.425	

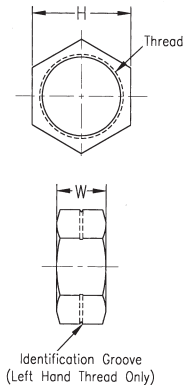

Related Products